



PATHWAYS to PROGRESS

Shaping the Future
of Transportation



March 16-19, 2025
RAISING CANE'S RIVER CENTER
BATON ROUGE, LA

>>> www.ltrc.lsu.edu/ltc_25



CONFERENCE HOSTS



River Center Maps.....	4	Tuesday (8:00 a.m.–8:50 a.m.)	16
Conference Information	5	Tuesday (9:10 a.m.–10:00 a.m.)	17
LTC App and Social Media	6	Tuesday (10:30 a.m.–11:20 a.m.)	18
Downtown Restaurant Map	7	Tuesday (1:00 p.m.–1:50 p.m.)	19
Graduate Student Poster Presentations	8	Tuesday (2:10 p.m.–3:00 p.m.)	20
Program At-a-Glance	10	Tuesday (3:30 p.m.–4:20 p.m.)	21
Session Descriptions	12	Wednesday (8:00 a.m.–8:50 a.m.)	23
Monday (1:00 p.m.–1:50 p.m.)	12	Wednesday (10:30 a.m.–11:20 a.m.)	24
Monday (2:10 p.m.–3:00 p.m.)	13	Wednesday (11:40 a.m.–12:30 p.m.)	25
Monday (3:30 p.m.–4:20 p.m.)	14	Conference Committee Members	28
Monday (4:40 p.m.–5:30 p.m.)	15	PDH Documentation Form	29



LOUISIANA TRANSPORTATION

20 CONFERENCE 25

THANK YOU TO OUR CONFERENCE SPONSORS

Platinum



Silver



Bronze



RAISING CANE'S RIVER CENTER MAPS

Second Floor/Level 2

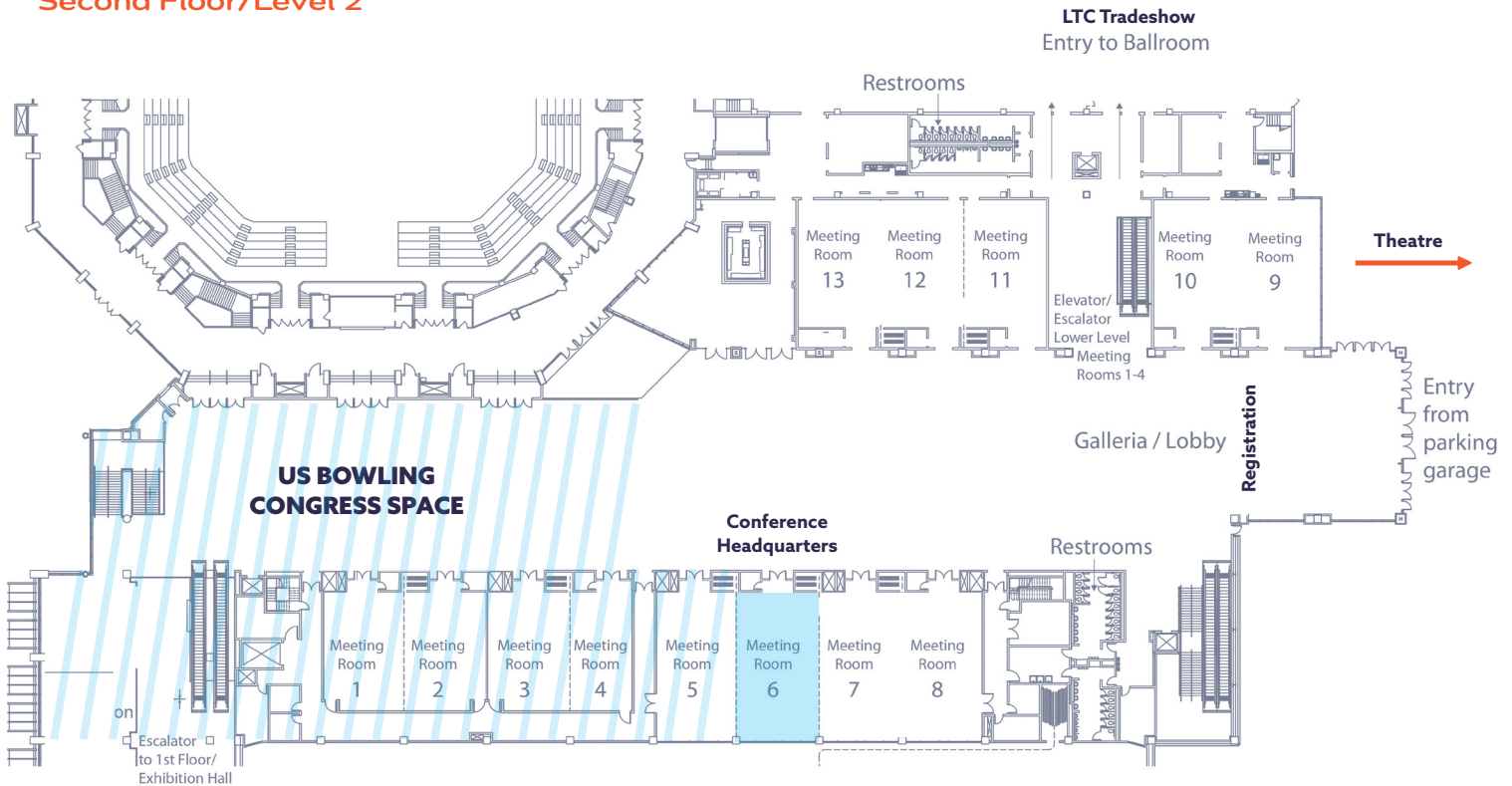

First Floor/ Lower Level Meeting Rooms 1-4

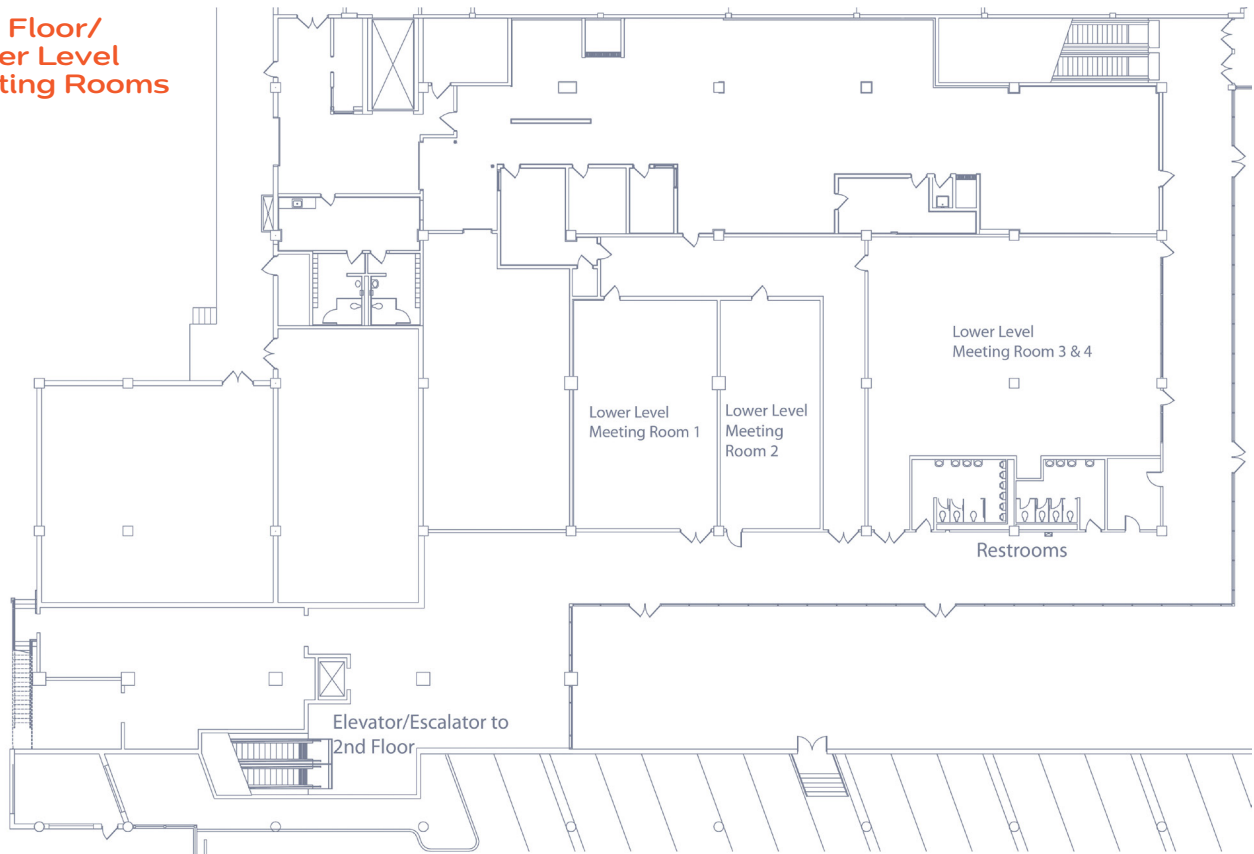

CONFERENCE INFORMATION

Conference Headquarters

The 2025 Louisiana Transportation Conference Headquarters is located in Meeting Room 6 on the second floor (Level 2). Conference Headquarters will be open Sunday 2 p.m.-5 p.m.; Monday 7 a.m.-5:30 p.m.; Tuesday 7 a.m.-4 p.m.; and Wednesday, 7 a.m.-11:30 a.m. If you have special needs during the conference, visit Conference Headquarters, and every effort will be made to accommodate your request.

Downtown Dining Options

Please note that Monday and Wednesday lunches are on your own. Tuesday lunch will be provided in the Ballroom. A QR code with a map of restaurants within walking distance is provided on page 7, courtesy of Visit Baton Rouge.

Badge/Name Tag

Please remember to wear your 2025 Louisiana Transportation Conference badge/name tag at all times, as this is your admission to all events.

PDH for Engineers and Land Surveyors

The program provides abstract information and a schedule of sessions, including the annual engineer/land surveyor license requirement for ethics/boundary surveys. Ethics will be offered only once at the 2025 LTC, immediately following the Monday morning General Session. Please plan accordingly. Pages 29-30 of this program provide a detachable register to keep track of the sessions attended and number of PDHs accumulated. Please note that LTC Conference Management does not verify PDHs; this is up to the attendee to document.

Industry Exhibits

The LTC Tradeshow will take place during the following times in the River Center Ballroom:

Monday 3:00 p.m., *Ballroom will open for afternoon break*
5:30 p.m. to 7:30 p.m., *Industry Reception*

Tuesday 7:00 a.m. to 3:30 p.m.

Speaker Preparation

A laptop and sample room setup will be available in the registration area for speakers to use in preparation for presentations.

Transportation Excellence Awards

An awards ceremony will be held during the General Session on Monday (8:30 a.m.-10:30 a.m.) in the River Center Theatre.

Conference Evaluation and Presentations

A conference evaluation survey will be sent to you electronically after the conference. Please take a few minutes to respond to the survey so we can gain your valuable input as we plan the next Louisiana Transportation Conference.

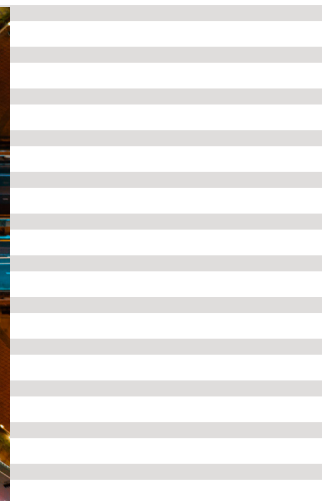

LET'S STAY CONNECTED!

LTC Social Media

Follow the Louisiana Transportation Research Center on LinkedIn (<https://www.linkedin.com/company/louisiana-transportation-research-center/>) for real-time conference photos. **Use #LTC2025 to share your own posts.**

LTC App

We are excited to continue our partnership with Grupio to bring you a seamless mobile experience at LTC!

- ✓ **Access the schedule, sponsors, and exhibitors**
- ✓ **Create a personalized session schedule**
- ✓ **Stay updated with real-time event details**

How to Download the Grupio App

Search for "Grupio" in:

- » App Store (iOS)
- » Google Play (Android)

Open the App & Search for:

- » Event Code: ltc25
- » Or find LTC in the event list

Log In with Your Credentials

- » **Username:** Your LTC registration email
- » **Password:** LTC

Prefer a Web Version?

Visit www.grupio.com/ltc25 or scan the QR code below!

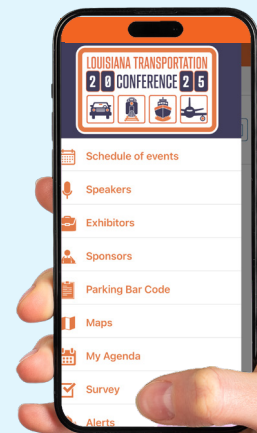



EXPLORE DOWNTOWN BATON ROUGE

Scan the QR code below to discover restaurant options, shopping, nightlife and attractions in Downtown Baton Rouge.



POSTER PRESENTATIONS

Visit the following graduate student projects in the Ballroom Lobby on Tuesday, March 18.

If you have any questions, please contact Moderator Vijaya (VJ) Gopu, LTRC Associate Director, External Programs at V.Gopu@la.gov.

Morning Poster Session

8:50 AM - 11:20 AM

Wave Impact Assessment on Highway Embankments from Hurricanes Using Measured Data in Coastal Louisiana

Abhishek Tiwari and Jay X. Wang
Louisiana Tech University

Lignin Extraction from Agricultural Waste and its Application to Asphalt Binder

Md Reazul Islam Jamil, Nafisa Tarannum, Nazimuddin M. Wasiuddin, and Joan Lynam
Louisiana Tech University

Development of DSR-Based Ductility and Force Ductility Tests for Asphalt Binders

Nafisa Tarannum and S.M. Rahat Rahman
Louisiana Tech University

Development of a Thermodynamic Test Method to Understand Compatibility Between Waste Plastic and Asphalt Binder

Shahjalal Selim, Md Reazul Islam, Nazimuddin M. Wasiuddin, and Dr. Andrew Peters
Louisiana Tech University

Advanced Structural Analysis and Sensitivity Evaluation of Framed Structures under Wind Loading Using SAP2000

Mani Ratna Subedi, Farid Hosseinpour, and Firouz Rosti
McNeese State University

Older Road Users Safety in Louisiana: Understanding the Crash Contribution Factors

Farooq Azam Khanzada, Xiaoduan Sun, and Elisabeta Mitran
University of Louisiana at Lafayette

A Comparative Analysis of Interpretable Spatially-Hybrid Machine Learning Models for Vehicle Availability Prediction

Kelvin Asamoah Terkper, Milhan Moomen, M. Ashifur Rahman, Nurul-Haq Mohammed, Waseem A. Khan, and Julius Codjoe
University of Louisiana at Lafayette

Resilient Reinforcement Learning for Voltage Control in an Islanded DC Microgrid Integrating Data-Driven Piezoelectric

Kouhyar Sheida and Farzad Ferdowsi
University of Louisiana at Lafayette

Afternoon Poster Session

1:00 PM - 3:30 PM

Monitoring of Transportation Infrastructure Deformation in East Baton Rouge Parish Using InSAR Techniques

Desmond Kangah, Ahmed Abdalla, and George Voyiadjis
Louisiana State University

Durability Investigation of Sustainable Smart Cementitious Composites

Khalilullah Taj and Yen-Fang Su
Louisiana State University

Optimization of Self-Sensible Louisiana-Sourced Ultra-High Performance Concrete: Balancing Mechanical Strength, Piezoresistivity, and Cost with Hybrid Fiber Reinforcement

Masoud Pasbani, Manjula Ramancha, Khalilullah Taj, Yen-Fang Su, and Ayman Okeil
Louisiana State University

Evaluation of Artificial CPT Prediction Techniques for Geotechnical Site Variability Analysis

Pezhman Moradi, Yazan Al-Harashsheh, Masoud Nobahar, and Murad Y. Abu-Farsakh
Louisiana State University

Real-Time FPGA-Based Driver Drowsiness Detection System for Vehicles Using Vivado High-Level Synthesis (HLS) Tools

Emmanuel Essel, Fred Lacy, and Yasser Ismail
Southern University

Exploring the Influence of Transportation Equity Factors on Pedestrian Crashes in Louisiana

Nurul-Haq Mohammed, Milhan Moomen, M. Ashifur Rahman, Kelvin A. Terkper, and Julius Codjoe
University of Louisiana at Lafayette

Perceptions of Electric Vehicle Adoption Among Louisiana Residents: A Structural Equation Modeling Analysis

Siam Junaed, Nazmus Sakib, M. Ashifur Rahman, Julius A. Codjoe, and Elisabeta Mitran
University of Louisiana at Lafayette

WELCOME TO BATON ROUGE!



SCAN TO SEE ALL THERE IS TO EXPLORE.

Visit **BATON
ROUGE**

#EXPLOREBATONROUGE

PROGRAM-AT-A-GLANCE

Sunday, March 16

2:00 p.m.–5:00 p.m.

Conference Registration, *River Center Galleria*

Monday, March 17

7:00 a.m.–5:30 p.m.

Conference Registration, *River Center Galleria*

7:00 a.m.–8:15 a.m.

Continental Breakfast, *River Center Galleria*

7:00 a.m.–8:15 a.m.

Secretary's Breakfast, *River Center Lower Level Meeting Rooms 3-4* | **BY INVITATION ONLY**

8:30 a.m.–10:30 a.m.

General Session and Transportation Awards Ceremony, *River Center Theatre*

10:30 a.m.–10:45 a.m. | Break

10:45 a.m.–11:45 a.m. | Engineering Ethics, *River Center Theatre*

11:45 a.m.–1:00 p.m. | Lunch (*on your own*)

1:00 p.m.–1:50 p.m.

Concurrent Sessions, *River Center*

- 1: Americans with Disabilities Act Transition Plan Process (LL Room 1)
- 2: Get the *Skid* Out of Here! (LL Rooms 3/4)
- 3: Digital Construction 01 (Rooms 7/8)
- 4: Dude, Where Is My Self-Driving Car? (Rooms 9/10)
- 5: Bridge Maintenance Projects (Room 11)
- 6: AASHTO Low Volume Guide (Rooms 12/13)

1:50 p.m.–2:10 p.m. | Session Break

2:10 p.m.–3:00 p.m.

Concurrent Sessions, *River Center*

- 7: RCA for More Sustainable Concrete Pavements (LL Room 1)
- 8: Thermoplastic Pavement Markings Inspection (LL Rooms 3/4)
- 9: Digital Construction 10 (Rooms 7/8)
- 10: The Why's and How's of Implementing Pavement Preservation Program: A Local Agency's Perspective (Rooms 9/10)
- 11: Improving Louisiana's Roadways through Technology (Room 11)
- 12: Louisiana Watershed Modeling Updates (Rooms 12/13)

3:00 p.m.–3:30 p.m. | Break, *River Center Ballroom*
Exhibits open at 3:00 p.m.

3:30 p.m.–4:20 p.m.

Concurrent Sessions, *River Center*

- 13: ROI for Safe Workplace Environments (LL Room 1)
- 14: I-20 Corridor Projects (LL Rooms 3/4)
- 15: RITIS Data and Analytical Platform: What Can RITIS Do for You? (Rooms 7/8)

16: Behind the Scenes with FHWA Louisiana: Empowering Transportation Grant Projects Statewide (Rooms 9/10)

17: Facilities and Lighting (Room 11)

18: Emergency Repair Projects (Rooms 12/13)

4:20 p.m.–4:40 p.m. | Session Break

4:40 p.m.–5:30 p.m.

Concurrent Sessions, *River Center*

- 19: Lions and Tigers and Utilities, Oh My! (LL Room 1)
- 20: EDC-7 Initiative: Strategic Workforce Development (LL Rooms 3/4)
- 21: MSY/Houma Airport Center of Excellence (Rooms 7/8)
- 22: Construction Work Zones (Rooms 9/10)
- 23: Breakdown of Public Works: Past, Present, Future (Room 11)
- 24: Why Transportation Safety Matters in the Workplace (Rooms 12/13)

5:30 p.m.–7:30 p.m.

Industry Exhibits/Reception, *River Center Ballroom*

Tuesday, March 18

7:00 a.m.–4:00 p.m.

Conference Registration, *River Center Galleria*

7:00 a.m.–8:00 a.m.

Continental Breakfast, *River Center Ballroom*

7:00 a.m.–3:30 p.m.

Industry Exhibits, *River Center Ballroom*

8:00 a.m.–8:50 a.m.

Concurrent Sessions, *River Center*

- 25: What the National Weather Service Can Do for You (LL Room 1)
- 26: Freight Optimization/Truck Parking (LL Rooms 3/4)
- 27: Engineering Resilience: Emergency Restoration of Sanibel Causeway and Ground Improvement Techniques for LA 1 Intracoastal Bridge (Rooms 7/8)
- 28: Construction Roundtable (Rooms 9/10)
- 29: ITS Advanced Maintenance Strategies (Room 11)
- 30: Environmental (Rooms 12/13)

8:50 a.m.–9:10 a.m. | Session Break



8:50 a.m.–11:20 a.m. | Graduate Poster Sessions

9:10 a.m.–10:00 a.m.

Concurrent Sessions, *River Center*

- 31: Senior Design Project Presentations (LL Room 1)
- 32: Outdoor Advertising (LL Rooms 3/4)
- 33: The Evolution of SUE for DOTD: Augmented Reality (Rooms 7/8)
- 34: CMAR Roundtable (Rooms 9/10)
- 35: Roundabouts: A Construction Curve Ball (Room 11)
- 36: Emergency Flood Flight and MS River Structures (Rooms 12/13)

10:00 a.m.–10:30 a.m. | Break, *River Center Ballroom*

10:30 a.m.–11:20 a.m.

Concurrent Sessions, *River Center*

- 37: Turning Safety Plans To Projects to Improve Local Road Safety (LL Room 1)
- 38: DBE Updates 49-CFR Final Rule (LL Rooms 3/4)
- 39: Shortline Rail/Shortage of Car Storage (Rooms 7/8)
- 40: DOTD District Administrator Panel Discussion (Rooms 9/10)
- 41: Leveraging Advanced Technologies in Transportation Planning and Design (Room 11)
- 42: Independent Cost Estimator (Rooms 12/13)

11:20 a.m.–1:00 p.m.

Lunch, *River Center Ballroom*

1:00 p.m.–1:50 p.m.

Concurrent Sessions, *River Center*

- 43: Louisiana Surveying Standards of Practice (LL Room 1)
- 44: Advancements in Asphalt Mixture Production and Construction (LL Rooms 3/4)
- 45: Project Permits (Rooms 7/8)
- 46: Less Crying and No More Dying: The Destination is Zero Deaths (Rooms 9/10)
- 47: ITS Operations (Room 11)
- 48: Navigating Modern Vessel Collision Evaluations and Solutions (Rooms 12/13)



1:00 p.m.–3:30 p.m. | Graduate Poster Sessions

1:50 p.m.–2:10 p.m. | Session Break

2:10 p.m.–3:00 p.m.

Concurrent Sessions, *River Center*

- 49: Analyzing Truck Loads for Permitting and Load Restrictions (LL Room 1)
- 50: Swamp Tank: A Bubbling Concoction of Research and Implementation (LL Rooms 3/4)
- 51: MUTCD and Traffic Engineering Department Updates (Rooms 7/8)
- 52: Port Panel/Legislation (Rooms 9/10)
- 53: Emerging Technologies: Future of Transportation Systems (Room 11)
- 54: I-20 Mississippi River Bridge at Vicksburg Status Update (Rooms 12/13)

3:00 p.m.–3:30 p.m. | Break, *River Center Ballroom*

3:30 p.m.–4:20 p.m.

Concurrent Sessions, *River Center*

- 55: Aggregates: How Industry Supplies DOTD (LL Room 1)
- 56: Swamp Tank: Discoveries are Endless in the Swamp (LL Rooms 3/4)
- 57: I-10 Calcasieu River Bridge Replacement Private Public Partnership Project (Rooms 7/8)
- 58: Legal Section by the Numbers (Rooms 9/10)
- 59: Traffic Engineering Design (Signals/Signs/Pavement Markings/Geometrics) (Room 11)
- 60: As-Is Use of Pavement Condition Data in Project Selection and Beyond (Rooms 12/13)

Wednesday, March 19

7:00 a.m.–11:30 a.m.

Conference Registration, *River Center Galleria*

7:00 a.m.–8:00 a.m.

Continental Breakfast, *River Center Galleria*

8:00 a.m.–8:50 a.m.

Concurrent Sessions, *River Center*

- 61: Design Construction of the Cameron Ferries (LL Room 1)
- 62: General Overview of Compliance Programs (LL Rooms 3/4)
- 63: Minimizing Right of Way Risk During Project Development (Rooms 7/8)
- 64: UAV: Policies, Procedures and Tracking Missions: Performing Cursory Checks on Topographic Surveys Using UAV Technology (Rooms 9/10)
- 65: Movable Bridge Projects (Room 11)
- 66: The Secret to Making Pedestrian Safety Improvement Projects Happen (Rooms 12/13)

8:50 a.m.–9:10 a.m. | Session Break



9:10 a.m.–10:00 a.m. | **Secretary's Roundtable, Theatre**

10:00 a.m.–10:30 a.m. | Break, *River Center Galleria*

10:30 a.m.–11:20 a.m.

Concurrent Sessions, *River Center*

- 67: Mobile River Bridge: Progressive Design-Build Procurement (LL Room 1)
- 68: GIS: Girding Information Silos (LL Rooms 3/4)
- 69: Highway Safety Trends and Summary of Post-Evaluations (Rooms 7/8)
- 70: Do You Want Photo and Lidar Data? How to Use the Louisiana Imagery Download App (Rooms 9/10)
- 71: Bridge Programs and Bridge Management (Room 11)
- 72: Complete Streets (Rooms 12/13)

11:20 a.m.–11:40 a.m. | Session Break

11:40 a.m.–12:30 p.m.

Concurrent Sessions, *River Center*

- 73: EDC-7 Initiative: Internally Cured Concrete (ICC) and High Visibility for Safety (LL Room 1)
- 74: Impactful Innovations (LL Rooms 3/4)
- 75: Birth of Emergency Ops: Katrina Emergency Response (Rooms 7/8)
- 76: Long Range Planning (Rooms 9/10)
- 77: Digital Integration of AASHTO Updates for Enhanced Engineering Decisions and Project Deliveries (Room 11)
- 78: TSMO and the DOTD Plan (Rooms 12/13)

SESSION DESCRIPTIONS

MONDAY 1:00 PM–1:50 PM

Session 1: Americans with Disabilities Act Transition Plan Process

Moderator: Cynthia Douglas
LL Meeting Room 1

This session will feature an overview of the DOTD ADA Transition Plan Process, including: What is a Transition Plan, Plan Development, Pilot Project, and Project Completion Schedule.

Brian Shamburger & Matt Poole, Kimley-Horn & Associates
Cynthia Douglas, DOTD

Session 2: Get the Skid Out of Here!

Moderator: Faren Spooner
LL Meeting Rooms 3-4

This session will describe the Maryland Aggregate Friction Testing Program. It will include the history and the current practice that utilizes the Dynamic Friction Tester (DFT) and the Three Wheel Polishing Device (TWPD) to classify aggregates for their friction characteristics and resistance to polishing under traffic. The Aggregate Friction Testing Program has been effective in selecting skid-resistant aggregates to be used in HMA mixes on Maryland roads.

Changes in Aggregate Friction Testing

Amanuel Welderufael, Maryland DOT

Pavement Texturing for Friction Recovery and Safety

Luanna Cambas & John Hunter, Skidabrader

Session 3: Digital Construction 01

Moderator: Patrick Icenogle
Meeting Rooms 7-8

The FHWA has a vision of how all US DOTs should conduct their Digital Project Delivery activities by 2031. This session will highlight the objectives of this vision, the driving motivations behind it, the timeline and milestones, and the support available to ensure the success of US DOTs. This session will also review the evolving roles and responsibilities of DOT consultants, contractors, and technology partners in relation to the Advancing BIM for Infrastructure National Strategic Roadmap, highlighting Louisiana's involvement with the Advanced Digital Construction Management Systems grant from the FHWA and exploring the cutting-edge technologies being demonstrated and tested in Louisiana through this grant initiative, including the development of automated, real-time worker presence notifications for the traveling public and the creation of advanced digital inspection tools. We will also discuss how DOTD is leveraging

the EDOT portal to integrate data from job site equipment, materials, contract management systems, GIS, and other digital devices to achieve these objectives.

Understanding the FHWA's Advancing BIM for Infrastructure National Strategic Roadmap

Terry Cline, Infotech

The Future of Construction- Advancing the Connected Jobsite

Joel VanDusen, HaulHub

Session 4: Dude, Where is My Self-Driving Car? State DOT Approaches to Navigating an Uneven Deployment Landscape for Autonomous and Connected Vehicles

Moderators: Joshua Harrouch & Greg Rodriguez
Meeting Rooms 9-10

Technology is all around us. States are not only interested but also incentivized from an economic development perspective through federal grant programs to consider the adoption of technologies that support safer, more efficient, and multimodal approaches to mobility. However, there continue to be questions about the safety, scalability, infrastructure needs, and timing of connected and autonomous vehicles. With national integration in focus, this session will feature an interactive discussion with different state DOT leaders and those supporting deployment efforts from a national and corridor perspective. One of the goals of the session will be to prioritize audience engagement through tools like Mentimeter and to support considerations around how connected and autonomous vehicles fit into Louisiana's transportation network. The session will also discuss findings from DOTD's CAV Working Group, which will provide a foundation for the panel discussion.

Joshua Harrouch, DOTD

Darran Anderson, Texas Department of Transportation

Alan Davis, Georgia Department of Transportation

Greg Rodriguez, Stantec

Session 5: Bridge Maintenance Projects

Moderator: Stephanie Doolittle
Meeting Room 11

This session will consist of presentations on three bridge repair projects completed by the HQ Bridge Maintenance (Section 51) in-house bridge repair and construction crews. The projects consist of the replacement of 10 steel girders at US 51 over Pass Manchac, the repair of 45 deteriorated timber piles by installing reinforced concrete encasements, and the construction of precast panel bridges using closure pours.

Encasement of Timber Piling Using Fiberglass Reinforcement; Construction of Precast Panel Bridges

Bradley Mistich, DOTD

Replacement of Deteriorated Steel Girders

Haylye Brown, DOTD

Session 6: AASHTO Low Volume Guide

Moderator: Brent Roussel

Meeting Rooms 12-13

This session will highlight several best practices for the use of the 2019 AASHTO Low Volume Guide.

Best Practices for Selecting Design Elements

Robert Isemann, DOTD

Drain Bridge: An Overview and Example

Christopher Menard, DOTD

MONDAY 2:10 PM–3:00 PM

Session 7: RCA for More Sustainable Concrete Pavements

Moderator: Michael Demouy

LL Meeting Room 1

The burgeoning volume of demolition waste, particularly concrete, poses a significant environmental challenge. In the US alone, hundreds of millions of tons are generated annually, depleting natural resources and contributing to landfill congestion. A promising solution is using recycled concrete aggregate (RCA) as a substitute for natural aggregate in concrete production. RCA is derived from the controlled demolition and processing of end-of-life concrete structures. Through a process involving crushing, screening, and removal of contaminants, RCA can be incorporated into new concrete products, offering several advantages. By conserving natural resources, reducing landfill reliance, and minimizing transportation costs, RCA contributes to a more sustainable and circular construction industry.

Mohamed Zeidan, Southeastern Louisiana University

Session 8: Thermoplastic Pavement Markings Inspection

Moderator: Laura Gibson

LL Meeting Rooms 3-4

Striping is an important safety feature to a roadway for both its presence and retro-reflectivity. It is important that the stripe is installed properly to provide that safety benefit over its expected lifetime. This session will explain how to inspect thermoplastic striping. How does one know if the stripe on the road meets DOTD specifications? Presenters will explain both the thermoplastic and the beads, DOTD specifications for a thermoplastic stripe, and how to determine if a stripe meets DOTD specifications.

Jerry Britt, PPG Traffic Solutions

David Christian, Potters Industries

Tom Still, Potters Beads

Session 9: Digital Construction 10

Moderator: Patrick Icenogle

Meeting Rooms 7-8

As the infrastructure industry faces growing demands for efficiency, transparency, and sustainability, digital delivery is emerging as a key solution to modernize project workflows and improve asset management. This session will explore how state agencies are leveraging digital delivery initiatives to enhance construction and inspection workflows. Central to this transformation is the incorporation of media for higher quality documentation, real-time data to drive better decision-making, and efficient data exchange between software applications. In recent years, DOTD has equipped project engineers and inspectors with cellular-enabled tablets and has adopted Headlight Fieldbook as a virtual field book for documentation and HaulHub EDOT portal for electronic batch ticketing.

Enhancing Efficiency—An Update on DOTD's EDOT Portal and E-Ticketing Implementation

Sean Miller, HaulHub

How Digital Delivery is Transforming Infrastructure Projects

DJ Weymouth, HeadLight

Session 10: The Why's and How's of Implementing Pavement Preservation Program: A Local Agency's Perspective

Moderator: Rudynah Capone

Meeting Rooms 9-10

This session will share how the Louisiana Local Technical Assistance Program (LTAP) center works with local governments and provides supplemental technical assistance to improve the overall condition of the road and street system, specifically through the implementation of a Pavement Preservation and Road Surface Management Program. LTAP's pavement preservation subject matter expert will co-present with experts from the City of Central and Lafayette Consolidated Government. They will not only explain the benefits of the preventive and proactive pavement preservation approach, but they will also describe how they maximized their limited funding, what technology they utilized, and what available resources they tapped into.

Local Government Perspective

Warren Abadie, Lafayette Consolidated Government

Local Agency Pavement Management

April Renard, Grey Engineering

Central, Livingston, Franklin, Jefferson Davis, City of Shreveport

Nick Verret, City of Natchitoches

Session 11: Improving Louisiana's Roadways through Technology

Moderator: Lucy Kimbeng
Meeting Room 11

The "The Road Ahead: New Frontiers for ITS in Louisiana" session will explore the evolution of intelligent transportation systems (ITS) in Louisiana, highlighting key deployments from the past, current advancements, and future prospects. We will examine current projects that are enhancing traffic management and safety and discuss innovative solutions aimed at revolutionizing mobility across the state.

With the looming threat of inclement weather, resiliency is a primary concern in our transportation network, and ITS is no exception. The "Designing for Resiliency: Powering ITS in Louisiana" presentation will explore options for providing reliable power to Louisiana ITS deployments for mission-critical applications, including "green" sources, which have the added benefit of helping decarbonize transportation.

The Road Ahead: New Frontiers for ITS in Louisiana
Clarke Chauvin, Neel-Schaffer

Designing for Resiliency: Powering ITS in Louisiana
Derrick Goudeau, Stantec

Session 12: Louisiana Watershed Modeling Updates

Moderator: Billy Williamson
Meeting Rooms 12-13

This session will provide a comprehensive introduction to the Louisiana Watershed Initiative (LWI), an overview of the methodologies behind LWI's Hydrology and Hydraulics (H&H) models, real-world user cases demonstrating the application of these models in flood risk analysis, and the latest updates on data availability to support community use.

Micaela Coner, DOA
Maryam Roostae, AECOM
Jie Gu, DOTD

MONDAY 3:30 PM-4:20 PM

Session 13: ROI for Safe Workplace Environments

Moderator: Marcus Sylvas
LL Meeting Room 1

There is a widespread incivility issue in the workplace. If you are a hierarchical leader in your organization, do you know the results of investing in the workplace culture and your team? In this session, we will discuss how leader effort affects the ROI for safe workplace environments.

Marcus Sylvas, LTRC/DOTD

Session 14: I-20 Corridor Projects

Moderator: Sawyer Glueck
LL Meeting Rooms 3-4

This session will showcase the design and plan development of H.007300 (Kansas-Garrett Connector & I-20 Improvements). The I-20 improvements involve the widening of the interstate toward the median from US 165 to east of the Garrett Road interchange with a 42" concrete barrier. Garrett Road will be widened to four lanes from Huntington Drive to LA 594 with the replacement of the existing Garrett Road bridge spanning I-20. A new roadway and bridge (Kansas-Garrett Connector) and five roundabouts are also proposed. Presenters will discuss the complexities of the designs as well as project coordination during plan development.

I-20 and US-165- East of Garrett Road
Aidan Eymard, DOTD

Kansas Lane-Garrett Road Connector
James Ellingburg, Lazenby

Session 15: RITIS Data and Analytical Platform: What Can RITIS Do For You?

Moderator: Julius Codjoe
Meeting Rooms 7-8

DOTD, Metropolitan Planning Organizations (MPOs), and their consultants and contractors have access to INRIX probe data and the accompanying analytics suite provided on the RITIS platform. During this session, an expert from UMD's CATT Lab will demonstrate new features and functions that are available to DOTD staff, consultants, and agency partners via the RITIS Traffic Map and Probe Data Analytics. Other presenters will discuss several use cases.

What?! I Didn't Know That RITIS Can Do That
Rick Ayers, UMD

Expanding Big Data Applications for Transportation Professionals
Matt Glasser, Arcadis

Using RITIS Platform for ITS Deployment Evaluation
Stephen Mensah, Stantec

Session 16: Behind the Scenes with FHWA Louisiana: Empowering Transportation Grant Projects Statewide

Moderator: Denise Lavalais
Meeting Rooms 9-10

This session will highlight the FHWA Louisiana Division's role in supporting transportation initiatives in Louisiana and provide practical guidance on navigating discretionary grant applications and effective project management.

Nikita Poche, FHWA
Jacquole Johnson, FHWA
Laura Phillips, FHWA

Session 17: Facilities and Lighting

Moderator: TJ Dunlevy

Meeting Room 11

Designing bridges is not the only responsibility of the DOTD Bridge and Structural Design Section. This section is the home to both the Mechanical Design and Electrical Design Units, which are responsible for the plumbing, HVAC, lighting, and power system designs for DOTD's 900+ buildings across the state. Additionally, the Electrical Design Unit administers the Interstate Lighting Program and oversees various roadway lighting projects. This session will feature two recent projects delivered by these design units.

District 61 HVAC and Electrical Restoration

Chris Arnold & Richard Foster, DOTD

Crescent City Connection Decorative Lighting Design

Cullen Ledet & Jonathan Gerhart, Modjeski & Masters

Session 18: Emergency Repair Projects

Moderator: Chad Roubique

Meeting Rooms 12-13

DOTD's infrastructure is aging, and structures do not always give warning signs before they fail. Structural and subsurface failures often result in immediate impacts to traffic and must be quickly addressed. The scope of work needed to address these types of projects typically requires more resources than district maintenance crews can offer; therefore, the utilization of emergency funding and contracting procedures is required. This work requires quickly designed sets of plans and expedited bidding procedures in order to begin the repair as quickly as possible.

LA 119 Emergency Slope Failure near Magnolia Plantation

Jared Taylor, DOTD

Bayou Grosse Tete Bridge Allison and Repair

TJ Manuel & Scott Lobell, DOTD

Senator Ted Hickey Structural Bridge Repairs

Scott Boyle, DOTD

MONDAY 4:40 PM–5:30 PM

Session 19: Lions and Tigers and Utilities, Oh My!

Moderator: JoAnn Kurts

LL Meeting Room 1

"We're off to see the Wizard, the Wonderful Wizard of Oz"! In this session, we will discuss how to avoid utility conflicts before construction, resolve utility conflicts during construction, and navigate the New URAF (Utility Relocation Assistance Funding) process.

JoAnn Kurts, DOTD

Session 20: EDC-7 Initiative: Strategic Workforce Development

Moderator: Paula Roddy

LL Meeting Rooms 3-4

The goal for the EDC-7 Initiative is to bring together the highway industry and Workforce Development community to develop new resources and innovative strategies to identify, train, place, and retain individuals in transportation careers. In this session, presenters will share past, current, and potential future solutions for training, outreach, and development that are being explored in Louisiana and across the nation. Each of these solutions is designed to meet the demand in highway construction, maintenance, and operations.

Paula Roddy, DOTD

Charles Harkless, FHWA

Session 21: MSY/Houma Airport Center of Excellence

Moderator: Heather Henson

Meeting Rooms 7-8

In this session, we will take a deep dive into Master Planning at the Louis Armstrong International Airport and see how unmanned systems are aiding Louisiana in becoming the nation's leader in all things unmanned.

Airport Master Planning with a Focus on Multimodal Interconnectivity

MSY Planning and Construction Staff

Louisiana's Holistic Approach to Emerging Technology Integration

George Rey, Unmanned Aircraft Systems Gulf of Mexico Center of Excellence (UGC)

Session 22: Construction Work Zones

Moderator: Dallas Ballmer

Meeting Rooms 9-10

This session will feature a discussion of various technologies and techniques used in work zones, as well as common deficiencies observed in the field.

New Technologies and Techniques in Work Zones

Dallas Ballmer, DOTD

Sequential Lighting

Daniel Selevan, pi-lit

Common Deficiencies in Louisiana Work Zones

Brett Morgan, DOTD

Session 23: Breakdown of Public Works: Past, Present, Future

Moderator: Edward Knight
Meeting Room 11

Engineers outside of Louisiana often ask, "What is the second D in DOTD?" The simplest answer is development, but a more nuanced answer is public works. DOTD was formed in the 1970s in a merger of the Department of Highways and the Department of Public Works. Over the years, the roles and responsibilities have shifted, and much of what remains of DPW resides in the Public Works in Water Resources Division. As staffing levels have fluctuated over the years, staff has sought to incorporate innovative technologies to more efficiently manage the Dam Safety and Levee Safety Programs.

Billy Williamson, DOTD

Session 24: Why Transportation Safety Matters in the Workplace

Moderator: Bria Lee-Hicks
Meeting Rooms 12-13

According to the Center for Analytics & Research in Transportation Safety, 811 people in Louisiana died in motor vehicle crashes in 2023. Risky human behaviors, such as driving impaired, continue to be a safety challenge in every form of transportation. The workplace is no different. In addition to the potential for loss of life, the cost of crashes includes wage and productivity losses, medical expenses, administrative expenses, vehicle damage, and insurance premiums. Employers helping to reduce crashes saves lives and reduces financial loss. Employer traffic safety programs advance road safety for their organizations, employees, family members, and communities at large. This session will explore how building an effective employer transportation safety program can improve driver behavior, reduce motor vehicle crashes, and save lives and money for the employer. During this session, participants will learn: why transportation safety should be a part of an organization's culture; how driver behaviors contribute to risk and liability; how Our Driving Concern enhances an organization's transportation safety program.

Session Knowledge Assessment: What will my organization do to effectively have a safe transportation system? How much money will be saved by reducing crashes for my organization? How can our organization utilize Our Driving Concern materials for employees?

Tracy LeMaire, National Safety Council

TUESDAY 8:00 AM-8:50 AM

Session 25: What the National Weather Service Can Do For You

Moderator: Michael Miller
LL Meeting Room 1

Come to this session to learn how to access, interpret, and use NWS data and services, including newer, probabilistic information. The data will include accessing precipitation information, river gauges, flood inundation mapping, hurricane forecast information, and other weather parameters. After explaining where to find that data, we will give you a brief overview of how to use and interpret the data that is most useful for the transportation industry. This will also include watches, warnings, and advisories commonly seen in Louisiana. We will leave time for questions at the end to ensure you walk away with an overview of how we can support your operations.

Lauren Nash, National Weather Service
Jim Mitchell, DOTD

Session 26: Freight Optimization/ Truck Parking

Moderator: Heather Henson
LL Meeting Rooms 3-4

This session will cover current advancements in truck parking to optimize safety and operational safety.

Stephen Holliday, DOTD

Session 27: Engineering Resilience: Emergency Restoration of Sanibel Causeway and Ground Improvement Techniques for LA 1 Intracoastal Bridge

Moderator: James Chatagnier
Meeting Rooms 7-8

This session will cover the emergency engineering design services for the Sanibel Causeway restoration after Hurricane Ian in 2022, which initially restored emergency vehicle access with over 1,000 trucks of earth fill and temporary sheet pile walls, followed by limestone rip rap for safety. The final phase included permanent steel sheet pile walls and scour countermeasures to protect against future storms. Furthermore, during the construction of the LA 1 Intracoastal Bridge, settlement of pile group footings was observed. To address this, DOTD used low-mobility grouting to stabilize four footings and mitigate future settlement concerns. This session will discuss the design methodology, instrumentation, and grouting techniques used.

Low-Mobility Grouting on the LA 1 Port Allen Canal Bridge
Miranda Perkins, DOTD

Restoration of Sanibel Causeway
Jim Phillips, Hardesty & Hanover

Session 28: Construction Roundtable

Moderator: Matthew Jones

Meeting Rooms 9-10

This session will feature a panel discussion involving Construction, Publications, and Plan Quality. We will discuss proposed changes, standard operating procedures, and specifications modernization.

Matthew Jones, Mike Vosburg, Brian Owens, Steven Mazur, & Ryan Nolan, DOTD

Session 29: ITS Advanced Maintenance Strategies

Moderator: Roy Esteven

Meeting Room 11

This session will explore the impact that natural disasters, particularly hurricanes, can have on Intelligent Transportation Systems (ITS) assets. The session explores the extensive damage these events can cause, from the physical destruction of infrastructure to the disruption of communication networks and degradation of public information systems. Using recent hurricanes in Florida & Louisiana as case studies, the session provides concrete examples of how advanced strategies & analytics can help create a resilient ITS infrastructure. The session will also focus on how data-driven applications can be harnessed to develop actionable insights and strategies for mitigating the impacts of natural disasters. Additionally, the session will review lessons learned from past natural disasters, offering insights into effective strategies, common challenges, and innovative solutions that have been implemented.

Insight to Action- Advanced Maintenance Strategies to Assess Damage and Improve Resilience

Neena Soans & Cody Lemoine, Arcadis

Session 30: Environmental

Moderator: Jena Milliner

Meeting Rooms 12-13

This session will provide an overview of the Environmental Justice outreach efforts for the I-10 Calcasieu River Bridge project and also an overview of the PEL study completed for the new Mississippi River Bridge project.

I-10 Calcasieu Bridge Improvements EIS - Enhanced Outreach

Lynn Maloney-Mujica, HNTB

Mississippi River Bridge PEL Study

Kara Moree, Atlas

TUESDAY 8:50 AM - 11:20 AM

Graduate Student Poster Presentations

Moderator: VJ Gopu

Ballroom Lobby

Please refer to page 8 for poster titles and authors.

TUESDAY 9:10 AM-10:00 AM

Session 31: Senior Design Project Presentations

Moderator: VJ Gopu

LL Meeting Room 1

In this session, teams of civil engineering students from Louisiana universities will present their senior design projects. These projects receive support from DOTD through its Support Program for Civil Engineering Studies.

Frameworks for the Future: Designing and Analyzing a Three-Story Steel Building

Trace Normand, LSU

Design of a Proposed Roundabout at the Intersection of LA150 and Tarbutton Road in Lincoln Parish

Zoria Deville, Ezra Esquivel, Matt Hein, & Clay Ray, Louisiana Tech

City of Youngsville Drinking Water Plant

Bethanee Hebert, Thomas Ronkartz, & Hayden Simon, UL-Lafayette

Session 32: Outdoor Advertising

Moderator: Jason Haraway

LL Meeting Rooms 3-4

This session will feature an introduction and overview of outdoor advertising and specific service signs. Learn what rules govern billboards on the side of the road, the new software DOTD has launched for outdoor advertising, and all about those blue logo signs on the side of the interstate.

101 on Outdoor Advertising

Travis Puls, DOTD

DOTD Outdoor Advertising Software

Chris Ohm & Ganesh Prabhakar, Delasoft

101 Specific Signs and TODD Signs

Johnny Durrett, Interstate Logos

Session 33: The Evolution of SUE for DOTD: Augmented Reality

Moderators: Stan Ard & Barrett Smith
Meeting Rooms 7-8

Dive into the cutting-edge integration of Augmented Reality (AR) with Subsurface Utility Engineering (SUE). This session will highlight how AR technology is transforming the way engineers and utility professionals can utilize SUE data to help avoid utility issues. We will also dive into how to take the SUE data from a DOTD-certified DGN and overlay the 3-D models of underground utilities onto real-world environments in the field. Additionally, we will show how this information can be utilized at the different stages of a project, from the initial design through project construction.

TJ Stokes, T. Baker Smith

Session 34: CMAR Roundtable

Moderator: Ryan Morvant
Meeting Rooms 9-10

This session will feature a discussion on CMAR- A Collaborative Process, Constructability and Innovation.

Nicholas Olivier, DOTD
Christina Brignac, DOTD
John Proskovec, Kiewit
Ed Sheuermann, Boh Brothers
Bob Schmidt, Huval and Associates
Rick Krebs, Krebs Corporation
Dan Bender, Innovation Contracting and Engineering
Gordon Nelson, Volkert

Session 35: Roundabouts: A Construction Curveball

Moderator: Michael Demouy
Meeting Room 11

The slowing and turning of traffic through a roundabout, which is effective for traffic management, can be less than ideal in terms of pavement wear. This means pavement stresses associated with roundabouts need to be addressed during design. In this session, we will highlight several proactive strategies for doing so.

Eric Ferrebee, American Concrete Pavement Association

Session 36: Emergency Flood Flight and Mississippi River Structures

Moderator: Michael Miller
Meeting Rooms 12-13

This session will cover the critical role of the US Army Corps of Engineers in managing Mississippi River structures during flood emergencies. The presentation will provide an in-depth look at the Corps' operations and strategies designed to mitigate flooding along one of the nation's most vital waterways.

Heath Jones, US Army Corps of Engineers

Session 37: Turning Safety Plans to Projects to Improve Local Road Safety

Moderator: Prasanth Malisetty
LL Meeting Room 1

LTAP administers the Local Road Safety Program (LRSP) and is closely working with local governments and roadway safety partners to develop and implement local road safety plans. Parishes and municipalities are encouraged to utilize these plans in prioritizing local road safety projects that may potentially be funded through the LRSP. This session will describe opportunities for traffic safety professionals and DOTD district engineers to collaborate with LTAP and local stakeholders in turning safety plans into projects. Presenters will also explain: (1) steps involved in submitting the LRSP project pre-application Letter of Intent; (2) eligibility requirements; and (3) technical assistance that LTAP can provide to assist project applicants throughout the application process.

Prasanth Malisetty, Svaapta Group
Leo Marreta & Peter Allain, LTAP

Session 38: DBE Updates 49-CFR Final Rule

Moderator: Paula Roddy
LL Meeting Rooms 3-4

This session will cover recent changes to the US DOT DBE Program, effective May 2024.

Paula Roddy, DOTD

Session 39: Shortline Rail/Shortage of Car Storage

Moderator: Heather Henson
Meeting Rooms 7-8

What makes shortline rail systems unique? This session will provide an answer, as well as providing an update on ongoing rail projects throughout Louisiana.

Ongoing and Planned Rail Projects in Louisiana

Kevin Keller, HDR

Louisiana Short-Line Success- National Leadership in Transportation Development

Brandy Christian, Patriot Rail

Session 40: DOTD District Administrator Panel Discussion

Moderator: Chad Roubique
Meeting Rooms 9-10

In this session, you are invited to join DOTD Operations for a lively panel discussion on the challenges and success of the daily operations at the heart of DOTD.

Chad Roubique, DOTD
Scott Boyle, DOTD: District 02
Eric Dauphine, DOTD: District 03
Seth Woods, DOTD: District 07
Troy Roussell, DOTD: District 08

Session 41: Leveraging Advanced Technologies in Transportation Planning and Design

Moderator: Stan Ard
Meeting Room 11

In the dynamic field of transportation planning and design, integrating advanced technologies is crucial for delivering precise and actionable data to optimize project efficiency. This session will explore the application of three transformative technologies—photogrammetry, LiDAR, and sonar—in the context of transportation projects. Participants will learn how these technologies revolutionize data collection and measurement processes. This session is designed for professionals in civil engineering, transportation planning and design, urban planning, and environmental studies. Attendees will leave with a comprehensive understanding of how to harness the power of photogrammetry, LiDAR, and sonar to achieve superior project outcomes.

Brad Holleman & Joey Coco, Forte & Tablada

Session 42: Independent Cost Estimator

Moderator: Nicholas Olivier
Meeting Rooms 12-13

This session will cover the process of Independent Cost Estimating for CMAR Projects.

Rick Krebs, Krebs Corporation
Dan Bender, ICE

TUESDAY 1:00 PM–1:50 PM

Session 43: Louisiana Surveying Standards of Practice

Moderator: Stan Ard
LL Meeting Room 1

This session meets the LAPELS 1 hour PDH requirement for Standards of Practice of Boundary Surveying in Louisiana.

Stan Ard, DOTD

Session 44: Advancements in Asphalt Mixture Production and Construction

Moderator: Saman Salari
LL Meeting Room 3-4

This session will explore the latest research on asphalt production and construction methods. It will specifically highlight Louisiana's initiatives to ensure the durability of asphalt mixtures made with alternative materials, as well as innovative approaches to assessing construction quality and consistency.

Establishing GWP Criteria for Asphalt Mixtures within Louisiana's BMD Framework

Louay Mohammad, LTRC/DOTD

Non-destructive Technique for Continuous Density Measurement: Louisiana's Experience

Moses Akenuna, LTRC/DOTD

Session 45: Project Permits

Moderator: Amy Barnum
Meeting Rooms 7-8

This session will discuss recent changes within the DOTD Right of Way Permits Unit regarding the processes for application, review, and approval of Access Connection Permits and State Highway Modification Projects. Presenters will cover the new Online Access Connection Permit Portal and how it is being used to apply for, track, coordinate, and approve DOTD Access Connection Permit requests, as well as the new procedures relative to applying for, completing the required agreements for, and completing the plan certification for a developer- or entity-led and -funded State Highway Modification Project.

New Process for Submitting & Processing Access Connection Permits

Jennifer Branton & Cristine Gowland, DOTD

New Highway Modification Permit Process

Toby Picard & Tim Hutchinson, DOTD

Session 46: Less Crying and No More Dying: The Destination is Zero Deaths

Moderator: Autumn Goodfellow-Thompson
Meeting Rooms 9-10

Destination Zero Deaths...Who? What? How? In this session, Destination Zero Deaths Regional Safety Coordinators invite you to explore the initiative of reducing fatalities and serious injuries on Louisiana roadways through their creative strategies to combat distracted and impaired driving as well as promote seat belt awareness. Transportation safety is a shared responsibility that affects everyone. We face significant behavioral challenges and infrastructure issues to enhance and ensure all road users reach their destination. Together, we can steer Louisiana toward a future where every road is safer. Let's drive change together!

Autumn Goodfellow-Thompson, DOTD
Amber Ashworth, DZD Southwest
Shelly Barrett, Northwest DZD Safety Coalition
Rebecca Boquet, SCPDC
Jay Cripple, New Orleans Regional Safety Coalition
Ronald Czajkowski, Acadiana Transportation Safety Coalition
April Higgins, Destination Zero Deaths
Destiny Kunefke, Rapides Area Planning Commission
Susan Mitchell, North Delta Regional P&DD

Session 47: ITS Operations

Moderator: Lucy Kimbeng
Meeting Room 11

ITS Operations involves Traffic Incident Management (TIM). TIM is a planned and coordinated multidisciplinary process to monitor, detect, respond to, and clear roadway incidents as safely and quickly as possible in order to restore traffic operations to normal conditions. This session will discuss an overview of DOTD's TIM program as well as dive into details of our Traffic Management Centers (TMCs) and Motor Assistance Patrol (MAP) throughout the state.

Traffic Incident Management at DOTD

Ryan Riviere, DOTD

DOTD MAP Operations

Richard Ardis, Serco

DOTD TMC Operations

Gordon McConnell, Serco

DOTD TMC Operations

MaryAnn Nickles, DOTD

Session 48: Navigating Modern Vessel Collision Evaluations and Solutions

Moderator: Kelly Kemp
Meeting Rooms 12-13

This session will cover vessel collision design methodology and an evaluation of existing bridge vessel collision vulnerability.

Vessel Collision Evaluations for Major Bridges

Matthew Lengyel, GM2

Improving Engineering Judgment for Vessel Collision Design

Zolan Prucz, Modjeski & Masters

TUESDAY 2:10 PM-3:00 PM

Session 49: Analyzing Truck Loads for Permitting and Load Restrictions

Moderator: Haylye Brown
LL Meeting Room 1

This session will include presentations on analyzing superloads that need to cross bridges, using Weigh-In-Motion technology on bridges, and analyzing and posting bridges for Emergency Vehicles, such as fire apparatus trucks.

Analyzing Louisiana Unique Superloads

William Metcalf, DOTD

Development of an Automated Bridge Weigh-In-Motion System

Shane Boone, BDI

Analyzing and Posting for Emergency Vehicle Loads

Yan Seraphy Shen, DOTD

Session 50: Swamp Tank: A Bubbling Concoction of Research and Implementation

Moderator: Tyson Rupnow
LL Meeting Rooms 3-4

Swamp Tank is a fast-paced, quick-hitting session aimed at rapidly disseminating research results from LTRC's Research Division. Presenters will have 5-6 minutes to showcase their research project, including the reasons for completing the project, research results, and implementation benefits to DOTD.

Holistic and Practical Approach for Assessing Flood Risks of Low Volume Asphalt Roads

Qiming Chen, LTRC/DOTD

Evaluation of Friction Performance of Selected Aggregate Sources using Three-Wheel Polishing Device

Zhong Wu, LTRC/DOTD

Implementing Stop-and-Go Inertial Profiler for Pavement Smoothness Assessment in Louisiana

Jun Liu, LTRC/DOTD

Performance Evaluation of the Geosynthetic-Reinforced Pile-Supported Embankments Design Methods

Murad Abu-Farsakh, LTRC/DOTD

Geotechnical Database Phase IV and Beyond

Gavin Gautreau, LTRC/DOTD

Field Evaluation of Geophysical Applications for DOTD

Nicholas Ferguson, LTRC/DOTD

TUESDAY 1:00 PM - 3:30 PM

Graduate Student Poster Presentations

Moderator: VJ Gopu
Ballroom Lobby

Please refer to page 8 for poster titles and authors.

Session 51: MUTCD and Traffic Engineering Department Updates

*Moderator: Myandra Gildon
Meeting Rooms 7-8*

During this session, presenters will discuss recent updates to the MUTCD and draft Traffic Engineering policy updates. There will also be a discussion on how Traffic Engineering Studies can be flexible based on the situation and location.

Traffic Engineering Policy Update

Andre Fillastre, DOTD

MUTCD Updates

John Broemmelsiek, FHWA

How Traffic Engineering Studies Can Be Flexible

Ryan Hoyt, DOTD

Session 52: Port Panel/Legislation

*Moderator: Julia Cormier
Meeting Rooms 9-10*

This session will feature a General Port Legislation Overview and an update on the Economic Climate of Ports, as Louisiana leads the nation in the number of ports.

Speakers from Port Legislators and Industry Experts

Session 53: Emerging Technologies: The Future of Transportation Systems

*Moderator: Rosalinda Deville
Meeting Room 11*

Waymo is expanding service around the nation with their latest \$5B investment, and soon Tesla is claiming market entry to also provide robotaxi service. Cities and states need to understand what this means and prepare accordingly. Furthermore, AI has the potential to transform many aspects of our transportation system. This session will explore the implications of autonomous vehicle (AV) fleet operations and how to prepare safety frameworks, performance measurements, infrastructure optimization (both physical and digital), and apply global best practices. Furthermore, a real-world application of AI driving decision support on the I-24 SMART Corridor will be examined.

Are You Ready for Robotaxis?

Corey Clothier, Arcadis

Transforming Decision Support Systems with AI (TDOT I-24 SMART Corridor)

Matt Davis, Stantec

Session 54: I-20 Mississippi River Bridge at Vicksburg Status Update

*Moderator: Mark Bucci
Meeting Rooms 12-13*

This session will provide a status update for I-20 Mississippi River Bridge at Vicksburg, discuss the structural and geotechnical challenges at the site, and describe DOTD's ongoing monitoring and mitigation efforts.

I-20 Vicksburg Bridge: Pier Movement Update and Additional Bridge Modifications

Jason Miles, Modjeski & Masters

Megan Bourgeois, Ardaman & Associates

TUESDAY 3:30 PM–4:20 PM

Session 55: Aggregates: How Industry Supplies DOTD

*Moderator: Brandon Johnson
LL Meeting Room 1*

Welcome to the wonderful world of aggregates! Aggregates are one of the most widely utilized materials on projects ranging from PCC to Asphalt Concrete and Base Material. The entire process of supplying aggregates to DOTD for use will be covered from start to finish in this session. Two major suppliers will outline this process, which entails the evaluation of the site's stratigraphy, drilling, blasting, loading, processing, and transport. Participants will gain valuable knowledge of how industry supplies the ever-evolving needs of DOTD.

Pine Bluff Sand & Gravel Quarry Operations

Chris Abadie, Pine Bluff Sand & Gravel

Vulcan Material Company Quarry Operations

Andrew Franklin, Vulcan Materials Company

Session 56: Swamp Tank: Discoveries are Endless in the Swamp

*Moderator: Tyson Rupnow
LL Meeting Rooms 3-4*

Swamp Tank is a fast-paced, quick-hitting session aimed at rapidly disseminating research results from LTRC's Research Division. Presenters will have 5-6 minutes to showcase their research project, including the reasons for completing the project, research results, and implementation benefits to DOTD.

The Pursuit of Sustainable Pavements

Louay Mohammad, LTRC/DOTD

Evaluation of the Miniature Concrete Prism Test (MCPT) for Use in DOTD

Zhen Liu, LTRC/DOTD

Non-destructive Testing (NDT) for Asphalt Density Measurement in Louisiana

Moses Akentuna, LTRC/DOTD

Analysis of Saturates/Aromatics/Resins/Asphaltenes (SARA) Grouping of Asphalt Binders in Louisiana

Saman Salari, LTRC/DOTD

Older Road Users' Safety in Louisiana

Elisabeta Mitran, LTRC/DOTD

Improved Incident Response through Coordinated, Interoperable Communications

Milhan Moomen, LTRC/DOTD

Redesign of Innovative Gate Arms (Ramp Closure Gate) Phase 1

Walid Alaywan, LTRC/DOTD

Analyzing Human Mobility for Active Transportation Planning in Louisiana

Ashifur Rahman, LTRC/DOTD

Session 57: I-10 Calcasieu River Bridge Replacement Private Public Partnership Project

*Moderator: Paul Vaught III
Meeting Rooms 7-8*

The \$2.3 billion Interstate 10 Calcasieu River Bridge megaproject in Lake Charles is a 5.5-mile corridor from near Ryan Street in Lake Charles to the I-210 and I-10 interchange in Westlake. DOTD and Calcasieu Bridge Partners (CBP) signed the public-private partnership (P3) in January 2024 to build the new bridge. DOTD issued the Notice to Proceed immediately upon financial close in August 2024, allowing the contractor, CBP, to begin work on the project. CBP is currently progressing in design. This session will highlight the status of this project and the elements that make this project a P3.

Gay Knipper, HNTB

Session 58: Legal Section by the Numbers

*Moderator: Andrew Barry
Meeting Rooms 9-10*

This section will feature a brief outline of the DOTD Legal Section and a breakdown of issues that were handled throughout the year.

Andrew Barry, Sam Pleasant, & Greg Hardy, DOTD

Session 59: Traffic Engineering Design: Signals, Signs, Pavement Markings, and Geometrics

*Moderator: Tyler Sherman
Meeting Room 11*

In this session, presenters will review lessons learned, common issues, and new innovations and ideas for Traffic Engineering Design.

To Sign or Not to Sign, That is the Question

Robert Willie, DOTD

Common Issues with Temporary Traffic Controls

Brandon Bouchere, DOTD

Traffic Signal Tidbits

Andre Fillastre, DOTD

Common Issues in Highway Design Practices & Challenge Solutions

Hoan Dang, DOTD

Session 60: As-Is Use of Pavement Condition Data in Project Selection and Beyond

*Moderator: Jason Lacombe
Meeting Rooms 12-13*

In this session, speakers will discuss the process of using data to select roadway segments for projects in the pavement preservation programs, determination of pavement treatments, and plans for how this data will be used to recommend program targets to improve the statewide pavement condition index.

Pavement Management 101/Where We Want to Go

Joseph Brown, DOTD

The Pavement Preservation Selection Process

Brian May, DOTD

Session 61: Design Construction of the Cameron Ferries

Moderator: Steven Sibley

LL Meeting Room 1

Critical energy infrastructure along the southwest coast of Louisiana is at risk due to limited transportation options. Cameron Ferry provides the only available crossing of the Calcasieu River below Lake Charles for approximately 50 miles. DOTD has begun construction of two new ferry boats to service this crossing—the first vehicle ferries to be built for the state in over 40 years. We will present the planning, design, construction, and challenges in each area that were met to deliver this project in our very own backyard.

Steven Sibley, DOTD

Design Features of the New Vessels

Joseph Cardella, Elliot Bay Design Group

Progress and Challenges of Ferry Construction

Walter Thomassie & Don Luparello, Thoma-Sea Marine

Session 62: General Overview of Compliance Programs

Moderator: Cynthia Douglas

LL Meeting Room 3-4

This session will feature an overview of all DOTD Compliance Programs, including Labor, Contract, DBE, OJT, and Title VI.

Contract Administration

Keisha Alexander-Green, DOTD

DBE Program

Rhonda Wallace, DOTD

DBE Certification

Shirley Ard & Warren Morgan, DOTD

DBE Payroll

July Halloran, DOTD

Labor Payroll Compliance

Angela Benn, DOTD

On-The-Job Training Program

Joyce Brignac, DOTD

Session 63: Minimizing Right of Way Risk During Project Development

Moderator: Donna Stinson

Meeting Rooms 7-8

This session will feature information on how changes to the right of way maps and construction plans impact right of way, how physical alterations to a property can affect its use (e.g., guardrails, elevation change, etc.), and why project changes to access matter.

Ashley Long & Justin Bickham, DOTD

Session 64: UAV: Policies, Procedures and Tracking Missions: Performing cursory Checks on Topographic Surveys Using UAV Technology

Moderator: Stan Ard

Meeting Rooms 9-10

In this session, come listen to DOTD's Aircraft Fleet Command Pilot and other team members discuss where to find the agency's policy on UAVs. Hear what we are currently doing in our work with UAVs, the benefits we are seeing, and how we are tracking all the details. We want to have an open discussion on what everyone in the agency is doing and how we can assist each other in our overall objectives. If you have UAV questions, come attend our session!

Jeremy Coffey, Mason Dupre, Jeremy Penton, & Dustin Smith, DOTD

Session 65: Movable Bridge Projects

Moderator: Mon Tapalla

Meeting Room 11

There are 136 movable bridges throughout Louisiana. Each bridge site presents unique challenges and requires innovative solutions from preliminary design through construction. Movable bridges are complex structures that often require the use of advanced software for design optimization. Additionally, complexities during construction require coordination between contractors and permitting agencies to minimize closures to both marine and vehicular traffic. This session will feature presentations from both design and construction, discussing several challenges associated with these bridge types.

Sheave Optimization Using Finite Element Analysis

Jeffrey Hastings, DOTD

St. Claude Ave. Bascule Bridge Rehabilitation of 1st Link Joints

Austin Holub, PCL Civil Constructors

John Williams, Wiss, Janney, Elstner Associates

Session 66: The Secret to Making Pedestrian Safety Improvement Projects Happen

Moderator: Laura Riggs

Meeting Room Rooms 12-13

In this session, we will explore how statewide data has been used to implement strategies from the Louisiana Vulnerable Road User Safety Assessment and discuss Phase 2 of our VRU Safety Assessment, which dug deeper to find the best project locations. We will also highlight case studies for various pedestrian safety improvements planned across the state and provide ideas and resources for developing pedestrian projects of all types.

Vulnerable Road User Safety Assessment Phase 2 & Various Case Studies

Jonathan Duhe, Neel-Schaffer

Various Case Studies

Brittany Rooney, Carrie Wiebelt, & Mark Morvant, DOTD

WEDNESDAY 9:10 AM–10:00 AM

Secretary's Roundtable

Moderator: Jacques Berry

Meeting Room Theatre

This session will feature a panel discussion with members of the Secretary's office and executive staff. Questions submitted to the panel prior to the LTC will be discussed.

WEDNESDAY 10:30 AM–11:20 AM

Session 67: Mobile River Bridge: Progressive Design-Build Procurement

Moderator: Christina Lewis

LL Meeting Room 1

This session will demonstrate how Progressive Design-Build was utilized to procure the Mobile Bay River Bridge and Bayway project. The discussion will include how the selected process was determined and share the latest status of the project.

Anna Hanks, DOTD

John Dietrick, Michael Baker International

Session 68: GIS: Girding Information Silos

Moderator: Chad Parker

LL Meeting Rooms 3-4

With more requirements being set for Model Inventory of Roadway Elements (MIRE), with ArcMap and Enterprise 10 soon to be unsupported, and with the need to modernize day-to-day applications utilized by DOTD personnel, the GIS team is on a rigorous path to complete the needed updates! Join us in this session to learn how the GIS team is using innovative ways to extract data, update and migrate applications, and develop new ways to share data with DOTD.

Application/GIS Enterprise Modernization

Brett Weidman, DOTD

Innovations in Data Extraction

Jason Carr & Monica Crout, DOTD

Updating DOTD Internal Reports

Jason Carr, DOTD

Session 69: Highway Safety Trends and Summary of Post-Evaluations

Moderator: Jennifer Mizzell

Meeting Rooms 7-8

How can our past inform us about the future? How has the post-COVID crash landscape changed and what do we do about it? What impact have recent projects had on crash patterns? Join us in this session for an exploration of recent data trends to understand recent crash patterns and how embracing a safe system approach will save lives.

Statewide Crash Trends Spotlight

Michael Allen, CARTS

The Good, the Bad, and the Ugly

Jim Chapman & David Worsham, DOTD

Session 70: Do You Want Photo and Lidar Data? How to Use the Louisiana Imagery Download App

Moderator: Stan Ard

Meeting Rooms 9-10

Do you often need high-quality imagery or elevation data for your project? Let DOTD's Certified Photogrammetrist and other team members show you where to go for currently available resources. In this session, we will walk through how to download the files and discuss several programs needed to work with this type of data. Learn what is to come for upcoming collection areas. Simple items, such as a unit setting or projection within your program, may be holding you back from excellent supporting data for your projects. Come join the session and let's discuss what could be!

Brenda Browning, Jeremy Penton, Dustin Smith, & Brett Wiedman, DOTD

Session 71: Bridge Programs and Bridge Management

Moderator: Valerie Tourres
Meeting Room 11

This session will cover the current status of DOTD's On-System and Off-System Bridge Programs. Additionally, an overview will be provided outlining the process for identifying and forecasting bridge needs using the state's chosen bridge asset management tool, AASHTOWare Bridge Management (BrM).

On-System Bridge Program Update

Brian Allen, DOTD

Off-System Bridge Program Update

Barbara Ostuno, DOTD

Bridge Asset Management Update

Ryan Percle, DOTD

Session 72: Complete Streets

Moderator: Lacey Fish
Meeting Rooms 12-13

In this session, presenters will review how pedestrian and bicycle accommodations can be addressed in a project for temporary traffic control. There will also be a discussion about PROWAG and the impacts it will have on your designs.

Pedestrians and Bicycles in Work Zones

Chris Fakouri, DOTD

PROWAG- Things You Need to Know

Patrick Gomez, FHWA

WEDNESDAY 11:40 AM-12:30 PM

Session 73: EDC-7 Initiative: Internally Cured Concrete (ICC) and High Visibility for Safety

Moderator: Tyson Rupnow
LL Meeting Room 1

This session will cover the research background and adoption efforts by Lafayette Consolidated Government in the area of Internally Cured Concrete (ICC). The presentation will cover the basics of ICC, background research efforts by LTRC, and several bridge applications in and around Lafayette, Louisiana.

TOPS

Tyson Rupnow, LTRC/DOTD

EPIC2

Allison Lognion, Lafayette Consolidated Government

Night Time Visibility

Bryan Costello, DOTD

Session 74: Impactful Innovations

Moderator: Jeffery Brown
LL Meeting Room 3-4

The Town of Addis is being transformed into a smart city using a pavement data collection app developed by RMT Technologies. Addis has increased the life of its road network by identifying and addressing pavement issues before they become more expensive repairs. One major benefit has been the ability to utilize road quality data for FEMA reporting and to have the data on hand when the next storm hits. The preservation method replaces the "worst first" approach that has failed our nation's infrastructure. The city can now be alerted when a road is deteriorating at a faster rate than previously measured. Similarly, service departments in the city can see suggested repairs and plan accordingly within their annual budget.

Addis—From Small Town to Smart City

David Toups, Town of Addis

Section 51 Magnetic Rail Girder Moving System

Bradley Mistich, DOTD

District 03 Brine/Water Adjustment Calculator

Nick Chachere, DOTD

District 07 Culvert Cleaner

Beau Istre, DOTD

Session 75: Birth of Emergency Ops: Katrina Emergency Response

Moderator: Michael Miller
Meeting Rooms 7-8

Join us for an insightful session exploring the transformative impact of Hurricane Katrina on emergency management practices across the United States. Before this catastrophic landfall, planners did not consider emergency management lines of effort to address the level of incident complexity. This session will review the architecture and innovative improvements at all levels of public and private engagement to do whole community planning and ensure core capabilities are achieved to support the communities and citizens they serve.

Neal Fudge, GOSHEP

Session 76: Long Range Planning

Moderator: Sarah Moss

Meeting Rooms 9-10

DOTD is updating its Statewide Transportation Plan to reflect a comprehensive, community-oriented transportation network for the next 30 years. This session will provide an overview of the current efforts underway for the update. It will also provide an overview of the 2024 Louisiana State Freight Plan and the Louisiana State Rail Plan.

Louisiana Statewide Transportation Plan

Paula Dowell, HNTB

2024 Louisiana State Freight Plan

Jason Duet, DOTD

2024 Louisiana State Rail Plan

Dean Goodell, DOTD

Session 77: Digital Integration of AASHTO Updates for Enhanced Engineering Decisions and Project Deliveries

Moderator: Derek Paille

Meeting Room 11

The geotechnical engineering industry is undergoing a digital transformation that promises to revolutionize design and construction practices. This session will explore how digital deliverables have evolved, transforming geotechnical processes and improving efficiency. Key areas of focus include the integration of standardized data exchange methods, such as the Data Interchange for Geotechnical and Geoenvironmental Specialists (DIGGS), and the use of advanced analytical techniques that comply with national and state specifications.

Digital Innovations for Streamlined Design and Construction Workflows in DOTD Projects

Xin Peng, Geosyntec

Gavin Gautreau, LTRC/DOTD

Session 78: TSMO and the DOTD Plan

Moderator: Joshua Harrouch

Meeting Rooms 12-13

As the nation's surface transportation system evolves to meet safety, mobility, and reliability challenges, a range of emerging and innovative operational strategies, together known as transportation systems management and operations (TSMO), are being applied by state and local transportation agencies. These strategies represent approaches that differ from traditional transportation improvements that rely heavily on building new lanes or roadways to address transportation problems. Several factors have led to the increasing recognition that TSMO is a critical component of a transportation agency's program, capable of producing significant performance improvements. In this session, we will discuss DOTD's plan to integrate TSMO in Louisiana.

DOTD TSMO Strategic Plan Update

Joshua Harrouch, DOTD

Chris Hilyer, Arcadis

NOTES

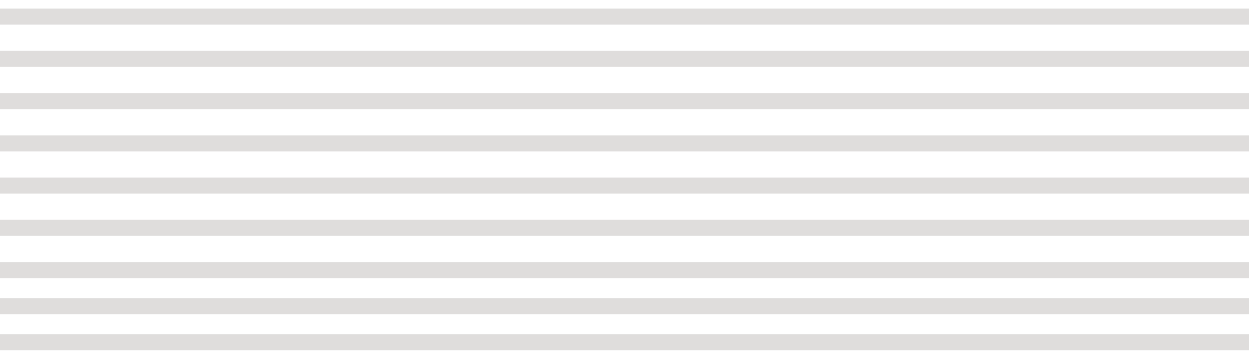

CONFERENCE COMMITTEE MEMBERS

Thank you to all of our committee chairs and their committee members for making the 2025 Louisiana Transportation Conference a success.

Chris Abadie
Barbara Aguillard
Keith Antee
Stanley Ard
Raegan Ball (FHWA)
Andrew Barry
Donald Bastin
Shawn Berg
Jacques Berry
Connie Betts
Todd Blount
Hannah Boggs
Joshua Boudreaux
Kaitlyn Boudreaux (GEC) (*Industry Relations Co-Chair*)
Jamie Boullion
Sandra Brady
Layne Brown (*Conference Registration Chair*)
Haylye Brown
Jeffery Brown
Kasey Browning
Mark Bucci
Brian Buckle (GEC)
Bud Cage
Rudynah Capone
Mark Chenevert
Dimetrie Chopin
Mary Leah Coco (*Conference Executive Committee Chair*)
Jody Colvin
Samuel Cooper, III (*Conference Program Committee Co-Chair*)
Samuel Cooper, Jr.
Christian Courson
Bryan Crouch
Tre Davis
Michael Demouy (CAAL)
Rosalinda DeVille
Barker Dirmann (ACECL)
Claire Dixon
Secretary Joe Donahue
Todd Donmyer
Brad Doucet
Cynthia Douglas
Courtney Dupre
Carmel Dysart

Cody Estilette
Chincia Ezenjiofo
Nick Fagerburg
Jennifer Farlough
Andre Fillastre
Julia Fisher-Cormier
Jordan Fontenot
Patrick Frazier
Vertie Gary
Jenny Gilbert (*Industry Relations Co-Chair*)
Autumn Goodfellow-Thompson
VJ Gopu
Chris Guidry
Anna Hanks
Dean Harrison
Joshua Harrouch
Jonas Hatfield
Paul Hendricks
Heather Henson
Jason Hooper
Christopher Hotard
Ryan Hoyt
Sheri Hughes
Robert Isemann
Trey Jesclard
Yolanda Jolivette
Phil Jones
Matthew Jones
David Jumper
Barry Keeling
Andre Kelly (AGC)
Lucy Kimbeng
Kristina Kleinpeter
Kim Lanceslin
Allison Landry (*Conference Operations Co-Chair*)
Melissa Lee
Robert Lott
Phillip Macaluso (*Conference Communications/Transportation Committee Chair*)
Rodney Mallet
Corey Mayeux (*Conference Program Committee Co-Chair*)
Kimberly McDaniel
Cheryl McKinney

Chris McMorris
Adriane McRae
David McVay
Patrick Mehaffey
Chris Melton
Mike Merrow
Michael Miller
Bradley Mistich
Tracey Morgan
Ken Naquin (AGC)
Melissa Neyland
Susan Nichols
Chris Nickel
Nicholas Olivier
Brian Owens
Peggy Jo Paine
Steve Parks
Erich Ponti (LAPA)
Michael Proctor
Kevin Reed
Laura Riggs
Will Ritter
Rebecca Rizzutto (*Conference Operations Co-Chair*)
Nicole Robinson
Paula Roddy
Chad Roubique
Shawn Roux
Tyson Rupnow (*Conference Executive Committee Co-Chair*)
Dawn Sholmire
John Soares
Faren Spooner
Todd Stevens (*Audiovisual/Information Technology Committee Chair*)
Marcus Sylvas
Paul Vaught
Kirk Wales
Thomas Warren
Kristopher Wascom
Garrett Wheat (*Program Committee Chair*)
Jon Wiggins
Billy Williamson
Stacey Wilton
Chad Winchester
Brenda Wolfe
Emily Wolfe (*Conference Publications Chair*)

2025 Louisiana Transportation Conference

Documentation of Professional Development Hours

Print Name _____

Date and Time	Session Title	PDH
Monday, 3/17/2025, following General Session <i>1.0 PDH available*</i>	Professionalism and Ethics in Engineering	
ETHICS PDH		

Monday, 3/17/2025 4:40 p.m.–5:30 p.m. <i>1.0 PDH available*</i>	19: Lions and Tigers and Utilities, Oh My!	
	20: EDC-7 Initiative: Strategic Workforce Development	
	21: MSY/Houma Airport Center of Excellence	
	22: Construction Work Zones	
	23: Breakdown of Public Works: Past, Present, Future	
	24: Why Transportation Safety Matters in the Workplace	

Date and Time	Session Title	PDHs
Monday, 3/17/2025 1:00 p.m.–1:50 p.m. <i>1.0 PDH available*</i>	1: Americans with Disabilities Act Transition Plan Process	
	2: Get the <i>Skid</i> Out of Here!	
	3: Digital Construction 01	
	4: Dude, Where Is My Self-Driving Car?	
	5: Bridge Maintenance Projects	
	6: AASHTO Low Volume Guide	
2:10 p.m.–3:00 p.m. <i>1.0 PDH available*</i>	7: RCA for More Sustainable Concrete Pavements	
	8: Thermoplastic Pavement Markings Inspection	
	9: Digital Construction 10	
	10: The Why's and How's of Implementing Pavement Preservation Program: A Local Agency's Perspective	
	11: Improving Louisiana's Roadways through Technology	
	12: Louisiana Watershed Modeling Updates	
3:30 p.m.–4:20 p.m. <i>1.0 PDH available*</i>	13: ROI for Safe Workplace Environments	
	14: I-20 Corridor Projects	
	15: RITIS Data and Analytical Platform: What Can RITIS Do for You?	
	16: Behind the Scenes with FHWA Louisiana: Empowering Transportation Grant Projects Statewide	
	17: Facilities and Lighting	
	18: Emergency Repair Projects	

Date and Time	Session Title	PDHs
Tuesday, 3/18/2025 8:00 a.m.–8:50 a.m. <i>1.0 PDH available*</i>	25: What the National Weather Service Can Do for You	
	26: Freight Optimization/Truck Parking	
	27: Engineering Resilience: Emergency Restoration of Sanibel Causeway and Ground Improvement Techniques for LA 1 Intracoastal Bridge	
	28: Construction Roundtable	
	29: ITS Advanced Maintenance Strategies	
	30: Environmental	
9:10 a.m.–10:00 a.m. <i>1.0 PDH available*</i>	31: Senior Design Project Presentations	
	32: Outdoor Advertising	
	33: The Evolution of SUE for DOTD: Augmented Reality	
	34: CMAR Roundtable	
	35: Roundabouts: A Construction Curve Ball	
	36: Emergency Flood Flight and MS River Structures	
10:30 a.m.–11:20 a.m. <i>1.0 PDH available*</i>	37: Turning Safety Plans To Projects to Improve Local Road Safety	
	38: DBE Updates 49-CFR Final Rule	
	39: Short-line Rail/Shortage of Car Storage	
	40: DOTD District Administrator Panel Discussion	
	41: Leveraging Advanced Technologies in Transportation Planning and Design	
	42: Independent Cost Estimator	

Date and Time	Session Title	PDHs
Tuesday, 3/18/2025 1:00 p.m.–1:50 p.m. 1.0 PDH available*	43: Louisiana Surveying Standards of Practice	
	44: Advancements in Asphalt Mixture Production and Construction	
	45: Project Permits	
	46: Less Crying and No More Dying: The Destination is Zero Deaths	
	47: ITS Operations	
	48: Navigating Modern Vessel Collision Evaluations and Solutions	
2:10 p.m.–3:00 p.m. 1.0 PDH available*	49: Analyzing Truck Loads for Permitting and Load Restrictions	
	50: Swamp Tank: A Bubbling Concoction of Research and Implementation	
	51: MUTCD and Traffic Engineering Department Updates	
	52: Port Panel/Legislation	
	53: Emerging Technologies: Future of Transportation Systems	
	54: I-20 Mississippi River Bridge at Vicksburg Status Update	
3:30 p.m.–4:20 p.m. 1.0 PDH available*	55: Aggregates: How Industry Supplies DOTD	
	56: Swamp Tank: Discoveries are Endless in the Swamp	
	57: I-10 Calcasieu River Bridge Replacement Private Public Partnership Project	
	58: Legal Section by the Numbers	
	59: Traffic Engineering Design (Signals/ Signs/Pavement Markings/Geometrics)	
	60: As-Is Use of Pavement Condition Data in Project Selection and Beyond	

Date and Time	Session Title	PDHs
Wednesday, 3/19/2025 8:00 a.m.–8:50 a.m. 1.0 PDH available*	61: Design Construction of the Cameron Ferries	
	62: General Overview of Compliance Programs	
	63: Minimizing Right of Way Risk During Project Development	
	64: UAV: Policies, Procedures and Tracking Missions: Performing Cursory Checks on Topographic Surveys Using UAV Technology	
	65: Movable Bridge Projects	
	66: The Secret to Making Pedestrian Safety Improvement Projects	
10:35 a.m.–11:20 a.m. 1.0 PDH available*	67: Mobile River Bridge: Progressive Design-Build Procurement	
	68: GIS: Girding Information Silos	
	69: Highway Safety Trends and Summary of Post-Evaluations	
	70: Do You Want Photo and Lidar Data? How to Use the Louisiana Imagery Download App	
	71: Bridge Programs and Bridge Management	
	72: Complete Streets	
11:20 a.m.–12:30 p.m. 1.0 PDH available*	73: EDC-7 Initiative: Internally Cured Concrete (ICC) and High Visibility for Safety	
	74: Impactful Innovations	
	75: Birth of Emergency Ops: Katrina Emergency Response	
	76: Long Range Planning	
	77: Digital Integration of AASHTO Updates for Enhanced Engineering Decisions and Project Deliveries	
	78: TSMO and the DOTD Plan	
TOTAL PDHs EARNED		

Total PDHs earned through attendance at the 2025 Louisiana Transportation Conference (14.0 available) _____

I hereby attest that I have attended the sessions documented on this form and that the cumulative PDHs total above is accurate.

SIGNATURE OF ATTENDEE



March 16-19, 2025

RAISING CANE'S RIVER CENTER
BATON ROUGE, LA

>>> www.ltrc.lsu.edu/ltc_25